

Area proposed to be filled
above flood level to increase
developable land

setbacks are not deemed to be practical.

Existing development limits riparian setbacks

Development infringements on riparian zone

Offset based on combination of mangroves edge and top of bank

Additional Parklands provide as offset for lost riparian zone.

Additional Parklands provide as offset for lost riparian zone.

Indicative alignment of cliff face/waters edge

Mangroves approximate extent up to 100m x 300m wide in this area

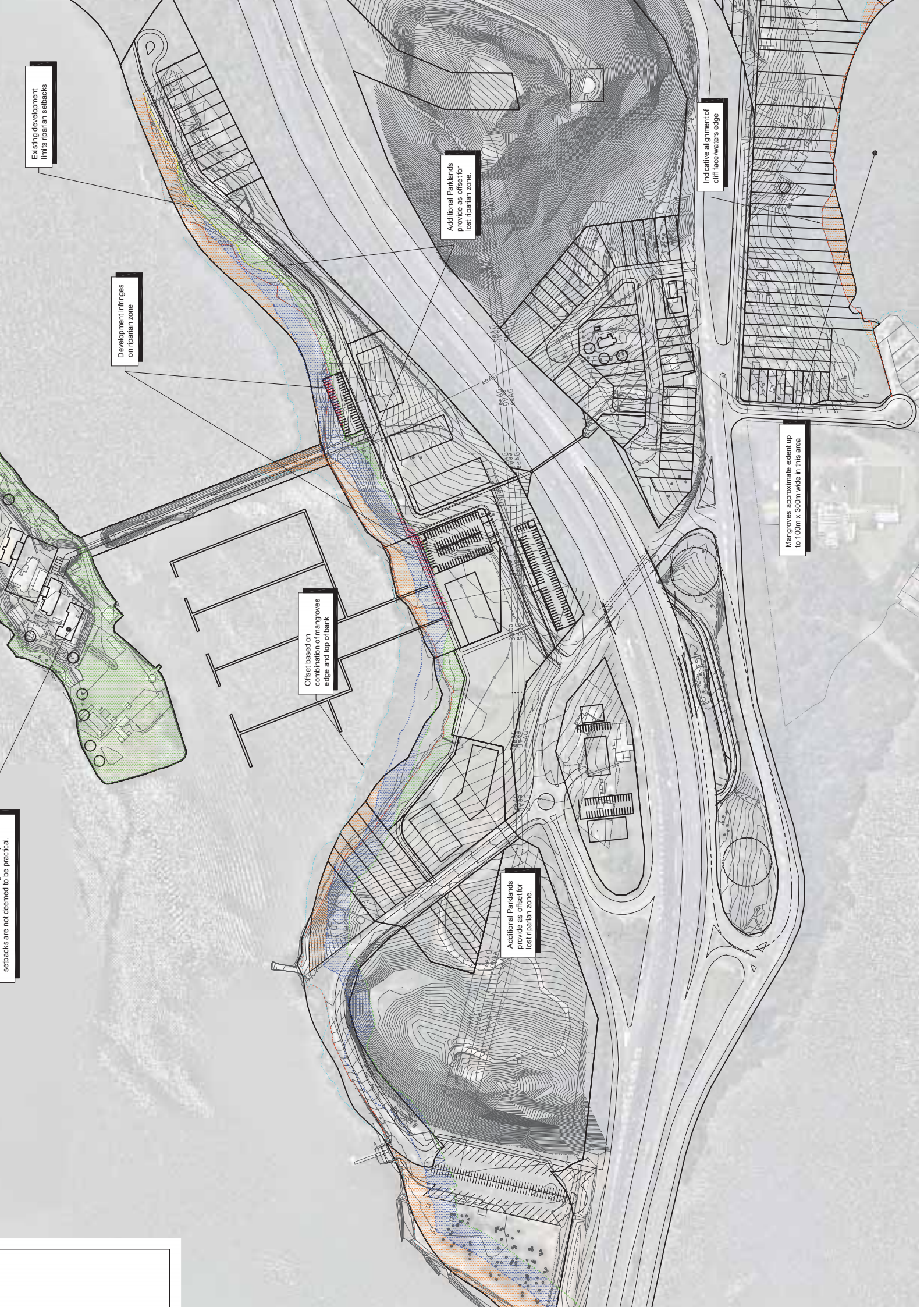

If early notice is achievable, evacuate.

Site generally lies above PMF.

